

ORDINANCE NO. 2018-21

**VILLAGE OF UNION GROVE
RACINE COUNTY, WISCONSIN**

**AN ORDINANCE PROVIDING FOR THE ATTACHMENT OF A PORTION OF THE
VILLAGE OF YORKVILLE, RACINE COUNTY, WISCONSIN, TO THE
VILLAGE OF UNION GROVE, RACINE COUNTY, WISCONSIN**

THE VILLAGE BOARD OF THE VILLAGE OF UNION GROVE, RACINE COUNTY, WISCONSIN,
DO ORDAIN AS FOLLOWS:

WHEREAS, the Village has received a petition for attachment of land from the Village of Yorkville in the County of Racine, Wisconsin, to the Village of Union Grove in the County of Racine, Wisconsin, for the following described subject property ("Property"):

A tract of land located in the Village of Yorkville, Racine County, Wisconsin,
described as follows:

Parcel I:

That part of the Southeast 1/4 of Section 19, Township 3 North, Range 21 East, bounded and described as follows: Begin at the Southeast corner of said Section 19; run thence North 01°27'50" West along the East line of said 1/4 Section 250 feet to the point of beginning of the following described real estate; thence continue North 01°27'50" West along the East line of said 1/4 Section, 150 feet; thence South 88°27'18" West parallel to the South line of said 1/4 section 497.44 feet; thence south 01°27'50" East parallel to the East line of said 1/4 Section 150 feet; thence North 88°27'18" East parallel to said South line 497.44 feet to the point of beginning. Reserving therefrom the East 45 feet in width for highway purposes. Said land being the Village of Yorkville.

Parcel II:

That part of the Southeast 1/4 of Section 19, Township 3 North, Range 21 East, bounded and described as follows: Begin at the Southeast corner of said 1/4 Section being the point of beginning of the following described real estate; thence North 01°27'50" West along the East line of said 1/4 Section 250 feet; thence South 88°27'18" West parallel to the South line of said 1/4 Section 497.44 feet; thence South 01°27'50' East parallel to the East line of said 1/4 Section 250 feet;

thence North 88°27'18' East along the South line of said 1/4 Section 497.44 feet to the point of beginning. Reserving therefrom the East 45 feet in width for highway purposes. Said land being in the Village of Yorkville.

The Property contains approximately 4.55 acres with a current population of 6 persons, including 2 adult electors, as defined in Wisconsin Statutes Section 66.0227. The Property is currently zoned A-2. A scale map reasonably showing the boundaries of the Property and the relation of the Property to the municipalities involved is attached hereto as Exhibit A; and,

WHEREAS, it appears that the petitioner has filed a duplicate of said Petition for Detachment with the Village of Yorkville, Racine County, Wisconsin; and,

WHEREAS, it further appears that the Petition has been signed by the sole owner of the Property within such territory, and by the only two adult resident electors; and,

WHEREAS, it further appears that all of the requirements of Section 66.0227 of the Wisconsin Statutes have been fully complied with; and

WHEREAS, it appears that the Village of Yorkville Board has determined that it is in the best interests of the Village of Yorkville and has approved the proposed detachment from the Village of Yorkville; and,

WHEREAS, it also appears to be in the best interests of the Village of Union Grove that the aforescribed Village of Yorkville territory be attached to the Village of Union Grove;

NOW, THEREFORE the Village Board of the Village of Union Grove, Racine County, Wisconsin, **by at least three-fourths majority**, hereby determines:

1. That the attachment petition is hereby approved; and,
2. That, upon satisfaction of all other statutory requirements, the Property be, and hereby is, detached from the Village of Yorkville and shall be attached to the Village of Union Grove; and,
3. That the Property shall continue to be zoned A-2 until such time as it may be re-zoned by the Village of Union Grove; and,
4. That the Village Clerk is hereby directed, within 30 days, to provide this Ordinance to the Village of Yorkville so that the Village of Yorkville is aware that the detachment/attachment has been approved, as set forth in Section 66.0227, Wis. Stat. The Village Clerk is further directed to give such notices as are required pursuant to Section 66.0227, Wis. Stat., i.e., to provide a copy of this Ordinance to the Village Clerk of the Village of Union Grove; to the State of Wisconsin Department of Administration; to the Clerk of the Union Grove Union *High School and Union*

Grove Elementary School Districts; to any company that provides any utility service to the area detached; and to record a copy with the Register of Deeds of Racine County, Wisconsin.

Adopted by the Village Board of the Village of Union Grove, this 10th day of December 2018.

VILLAGE OF UNION GROVE

By: Michael Aimone
Michael Aimone
Village President

Attest: Elizabeth M. Schwertfeger
Elizabeth Schwertfeger
Deputy Village Clerk--Treasurer

EXHIBIT A

LEGAL DESCRIPTION

A TRACT OF LAND BEING A PART OF THE SOUTHWEST 1/4 OF THE SOUTHEAST 1/4 OF SECTION 18, TOWNSHIP 3 NORTH, RANGE 21 EAST, IN THE COUNTY OF YORKVILLE, COUNTY OF RICHIE, STATE OF WISCONSIN, BOUNDED AND DESCRIBED AS FOLLOWS:

COMMENCE AT THE CORNER OF SAID SECTION

THENCE North 01 degrees 27 minutes 50 seconds West 701.4 feet TO A POINT; ALONG THE EAST LINE OF SAID 1/4 SECTION,

THENCE South 88 degrees 27 minutes 41 seconds West 400.0 feet TO A POINT; PARALLEL TO THE SOUTH LINE OF SAID 1/4 SECTION, TO A POINT;

THENCE South 88 degrees 27 minutes 41 seconds West 400.0 feet TO A POINT; PARALLEL TO THE EAST LINE OF SAID 1/4 SECTION, TO A POINT;

THENCE North 01 degrees 27 minutes 50 seconds East for a distance of 701.4 feet ALONG THE SOUTH LINE OF SAID 1/4 SECTION, TO THE POINT OF COMMENCEMENT. RESERVE AND THEREFOR THE EASTERLY 45.00 FEET FOR PUBLIC ROAD PURPOSES.

Together with and subject to covenants, easements, and restrictions in and on record.

Said property contains 4.35 acres more or less.

Village of Yorkville

Village of Union Grove

44.00'

S. 8127.16' W. 87.44'

453.44'

Village of Yorkville

452.44'

S 88° 21' 42" E 497.44'

44.00'

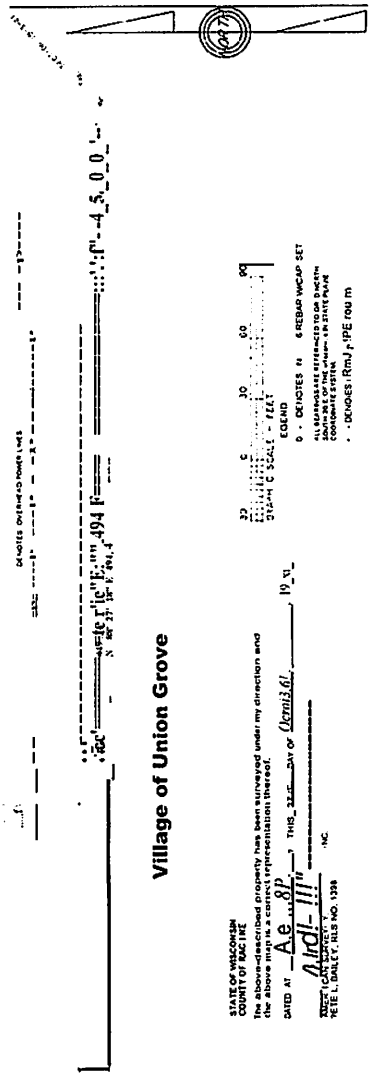

BOUNDARY SURVEY
PREPARED FOR: TRINITY EVANGELICAL
LUTHERAN CHURCH

DATE: 03/27/2014
APPROVED: [Signature]
DATE: 03/27/2014
SHEET NO: 1
FILE NUMBER: 140101010

B

TOWN OF YORKVILLE

1000 E. 1st ST. YORKVILLE, MISSOURI 63092
(616) 814-3172

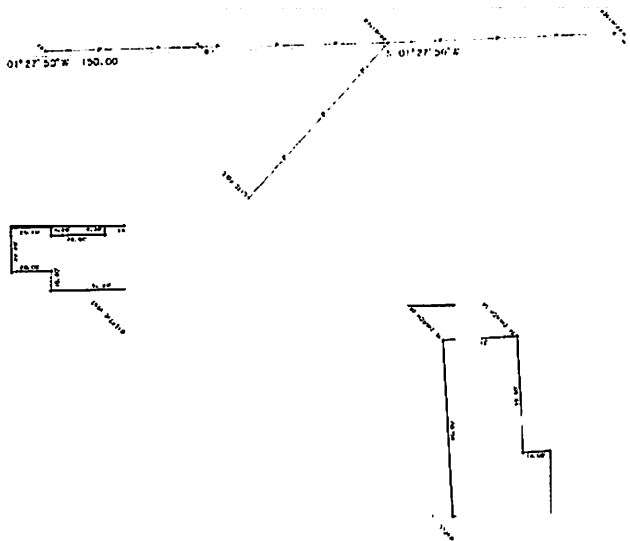

AMERICAN SURVEYING COMPANY, INC.



10/14/2014